

In-Line 1/8" Ball Check Valve NG-301



Application

For use with LNG liquid lines as an effective shut off utilizing ball and spring mechanism. 1/8" design fits compact piping systems.

Heavy duty spring and precision ball provide dependable service in LNG fuel applications.

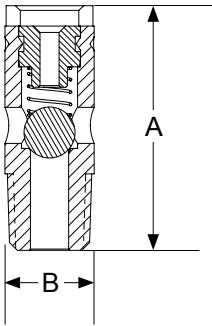

Features

- Materials selected specifically for compatibility with LNG
- Quick acting ball and spring mechanism
- Metal to metal seating provides durable service life
- 100% factory tested

Body	Brass
Spring	Stainless Steel
Spring retainer.....	Brass
Ball	Stainless Steel

Part Number	Inlet	Closing Pressure
NG301	1/8"	50 PSI

In-Line 1/2" Fill Check Valve NG-304

Application

For use with LNG fuel lines as an effective one way shut off utilizing soft seated design for quick acting response to flow.

Poppet design is ideal for LNG and resistant to particulates.

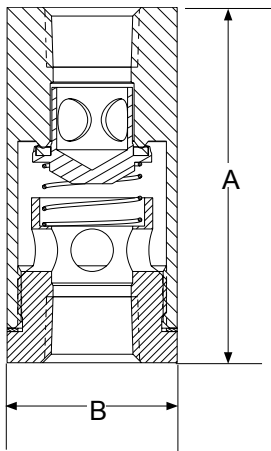

Features

- Materials selected specifically for compatibility with LNG
- Maximum inlet pressure 1000PSI
- PTFE seat provides positive shut off at cryogenic temperatures
- 100% factory tested

Body	Brass
Spring	Stainless Steel
Seat Disc	Teflon
Seat holder	Brass

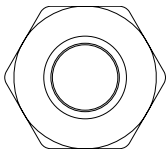

Part Number	Inlet/Outlet	Flow
NG304	1/2" NPTF	150 SCFM at 5 PSID